

Metal Driveshaft Installation

Covers Part #5451R



Tools Needed

- 2.5mm hex wrench
- 2.0mm hex wrench
- 8.0mm nut driver
- Small flat-tip screwdriver

Important Notes

- This kit fits models 5310 Revo, 5309 Revo 3.3, 4909 T-Maxx 3.3, and 4902 T-Maxx 2.5R. It **does not** fit 4910 T-Maxx, 5109 S-Maxx or 5110 SportMaxx.
- This kit is not for use with the Revo long travel rocker set.
- The middle or outer pushrod location on arm must be used for P1, P2, and P3 rockers.
- If you are using these shafts with part #5333R (adjustable wheelbase rear control arms), the driveshafts can come out of the drive cups in the +19mm position. To prevent this you will need to either replace the metal drive cups with part #5153R (extended drive cups, sold separately), **OR** reduce the down travel by installing the pushrod on the outer locations on the suspension arm.

Driveshaft removal

- Remove the wheel nut from the axle, and then slide the wheel and tire off of the axle.
- Slide the hex adapter off of the axle, and then push the axle pin out of the axle. **Tip:** Use a small flat-tip screwdriver to pop the adapter off of the axle pin. (A)
- Remove the screw pin from the diff output yoke, and then slide the output yoke and driveshaft off of the differential output shaft. (B)
- Collapse the two ends of the driveshaft together, and then pull the axle out of the hub carrier from the inside. Remove the entire driveshaft assembly from the suspension. (C)

Install metal driveshafts

- Remove the pivot balls from the upper and lower suspension arms to separate the hub carrier from the arms. (D)
- Attach the inner yoke of the 5451R driveshaft onto the output shaft of the differential. Line up the holes in the driveshaft yoke with the holes in the output shafts and secure it with a screw pin (included). (E)

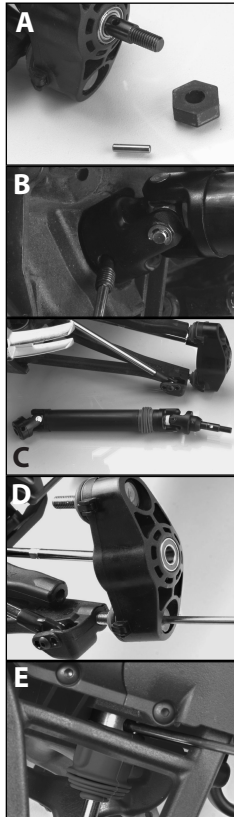

- Insert the axle through the bearings located inside of the hub carrier, and then the appropriate pivot ball back into the upper and lower suspension arms until they bottom out. Make sure to adjust camber as necessary. (F) **Note:** Adjust the camber using either the upper or lower ball only. If both are used, the shaft end may come loose.

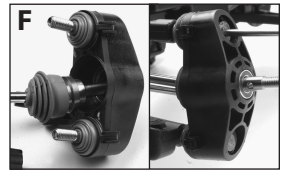

- Insert the axle pin into the hole in the axle, and then slide the hex adapter onto the axle. Key the slot in the hex adapter to the axle pin, then press it against the pin until it pops on. (G)
- Attach the wheels onto the hex hubs. Make sure the hex hubs are keyed into the wheels, and secure the wheels with the two 5.0mm nylon locknuts. This completes the assembly.

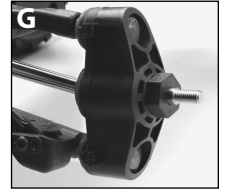

CVD Maintenance

The metal driveshafts are lubed from the factory and allow for extended maintenance intervals. It is still important to provide regular maintenance to ensure long life. Follow the tips below:

After every gallon of fuel:

- Pull the dust boots toward the middle of the shaft to inspect and clean the inner and outer shaft joints.
- Clean the joints and dust boots with denatured alcohol.
- Inspect drive cups and driveshafts for wear.
- Inspect the dust boots for wear.
- Re-lube the driveshaft joints. The recommended and factory applied grease for the driveshaft joints is the Traxxas part #2717 Thrust Bearing Lube.
- Push the dust boots back over the joints, making sure that the boots fit snugly. Note that the molded pins inside the dust boots for the output drive cups must key into the holes in the cups.

* Perform these steps after every half-gallon and after running in sand or conditions that include very fine dust.

If you have questions or need technical assistance, call Traxxas at

1-888-TRAXXAS

(1-888-872-9927) (U.S. residents only)

Driveshaft Assembly

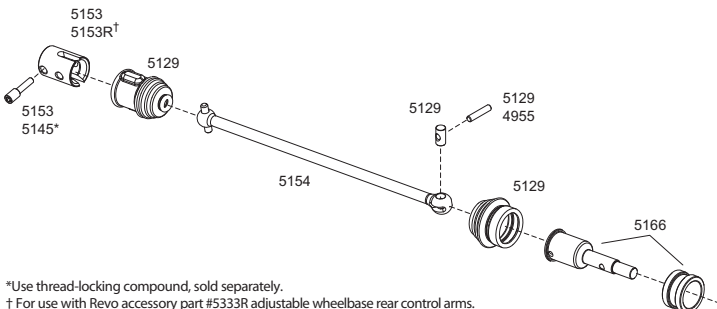

*Use thread-locking compound, sold separately.

† For use with Revo accessory part #5333R adjustable wheelbase rear control arms.

5451R	Driveshafts, Revo/ Maxx (steel constant-velocity) (assembled w/inner & outer dust boots)(for models w/ sealed pivot ball suspension & 3.8" wheels) (4).....	\$80.00
5153	Drive cups, inner (2) Revo/ Maxx (for steel constant-velocity driveshafts)/screw pin, M4/15 (2)	\$8.00
5154	Driveshaft, steel constant-velocity, Revo/ Maxx (shaft only, 128.5mm)/ drive cup pin (1)	\$10.00
5166	Stub axle, (1)/ axle sleeve (1) Revo/ Maxx (for steel constant-velocity driveshaft).....	\$7.50
5129	Rebuild kit (for Revo/Maxx steel constant-velocity driveshafts) (includes pins, dustboots, and lube for two driveshaft assemblies).....	\$7.00
5153R	Drive cups, inner (2) Revo (steel constant-velocity driveshafts) /screw pin, M4/15(2) (for use only with 5333R adjustable wheelbase rear suspension arms)	\$8.00